

A - PRESS ZONE.

FLAT 75X16

BEFORE COMP.

AFTER COMP.

ALLU. DEAD END

* TO BE SPECIFIED BY BIDDER

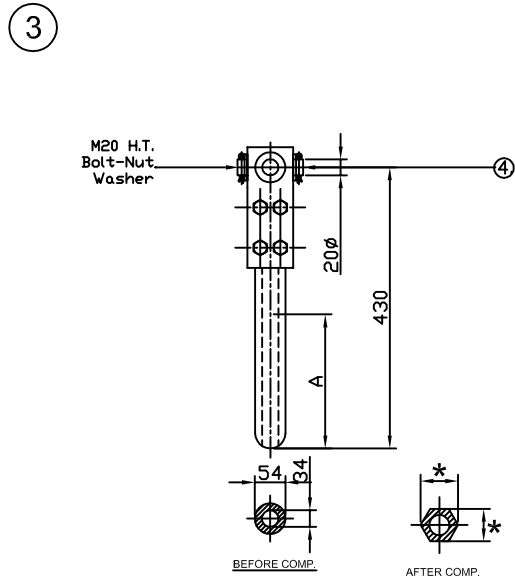

JUMPER.

BEFORE COMP.

AFTER COMP.

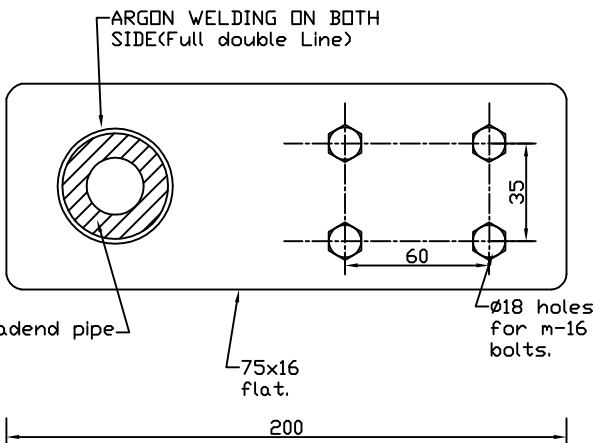

54x34 Deadend pipe

75x16 flat.

Ø18 holes for m-16 bolts.

VIEW.
SECTION AA.

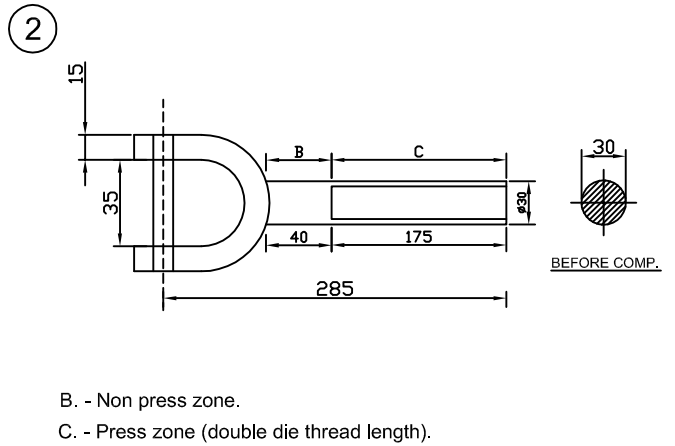

B. - Non press zone.

C. - Press zone (double die thread length).

FORGED STEEL DEAD END.

NOTES:-

- 1 - Steel dead end is forged steel single piece.
- 2 - All. Dead end - jumper are special grade alloy equal to AL59.
- 3 - Compression should be done as per zone shown.
- 4 - Argon welding should have enough ele. & mech. strength.
- 5 - All dimensions are in mm.
- 6 - Dimensions N.T.S.

4	NUT-BOLTS-WASHERS.	4Set.	M. S. HDG.
3	JUMPER.	1	ALL. ALLOY.
2	STEEL DEAD END.	1	F.S. , HDG.
1	ALL. ALLOY DEAD END.	1	ALL. ALLOY.
SR. NO.	DESCRIPTION	QTY.	SPECIFICATION

TENDER PURPOSE			
GUJARAT ENERGY TRANSMISSION CORPN.LTD. S.P.VIDYUT BHAVAN, RACE COURSE, VADODARA - 390 007			
(9) COMPRESSION DEAD END FOR AL-59 CONDUCTOR.			
DRAWN:	CHECKED:	APPD:	SIZE: A3
SCALE:	DATE:	DRG. NO: GETCO / E / 2L-STD / AL59-DTN / 004	SHEET: REV: 2 OF 2 R0